

BEAUTIFUL BATHS



VALLONE

BEAUTIFUL BATHS



Opposite: European-style plumbing fixtures enhance the vintage character of this claw-foot tub. The black legs of the skirted vanity chair provide striking contrast to the otherwise light palette.

Left: Silver finishes and graceful curves give the room the aura of a Victorian-Era hotel.

Before Julie Adelson and her friends enjoy a girls' night out, the group sometimes gathers in what may seem an unlikely place—her home's master bathroom. They sit on a chair with a flounced skirt at the vanity or array their cosmetics on the marble shelf over the sinks, touching up their makeup and sharing a pampering preparty.

"One time before a birthday celebration," Julie says with delight, "we had mini cupcakes and champagne."

On a day-to-day basis, the bathroom is more likely to be shared with Julie's youngest daughter, who has soaked in the claw-foot bathtub more than her mom has, or with the

family dog, who gets a deluxe canine cleaning with the handheld showerhead.

That combination of luxurious glamour and everyday function succeeds beautifully in this Phoenix bath, which is part of an upper-level master suite laid out in a large circle that includes a dressing area, exercise room, coffee niche, and bedroom.

In designing the bath, which is part of a new home built on an old footprint, the primary goals were to keep the space in scale and to make it light, bright, airy, and feminine, yet not over the top for Julie's husband, Tom.

The result is a balance of traditional and funky style, says designer Berkley Vallone,

BEAUTIFUL BATHS 91
2009

VALLONE

residential + commercial interiors

BEAUTIFUL BATHS



In Praise of Marble

THIS CLASSIC SURFACING MATERIAL IS BOTH PRACTICAL AND SENSUOUS.

Carrara marble is visually abundant in this Arizona home's master bath. It's not just on the floor and the countertop; it's used as wainscoting and shelves as well. Designer Berkeley Vallone ensured visual interest by choosing tiles of different sizes and shapes for the floor and shower, and by softly curving the marble shelf supports. The reflective surface picks up natural light and offers other benefits. "It doesn't show wear and tear the way a painted surface does and it's very easy to clean," homeowner Julie Adlison says. "And it's nice having marble in the Arizona desert because marble helps keep everything cool."

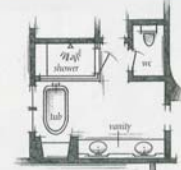

who describes the bath as a "fun, girly space, but with a fresh spa feeling."

The cabinets and countertops are all classic marble, with vintage-style sconces and a crystal chandelier providing a bit of glamour. The lights and mirrors add a reflective quality that capitalizes on the sunshine flooding through the window, which frames an enviable view of Camelback Mountain.

Key to the room's fresh feeling is the quiet palette, featuring a soft, soothing blue, anchored by stretches of white carrara marble. Vallone shaped the marble to create a highly functional yet decorative ledge behind the sinks to reduce clutter on the counter.

The shelf is Julie's favorite detail. "I can put

pretty things or products I use every day right at my disposal," she says.

Old-fashioned fixtures include polished-nickel shower faucets and showerheads, while the sconces hint of Hollywood. "I'm very traditional but really open to throwing in modern or Art Deco," Julie says. "I like that twist!"

The bathroom's traditional elegance and class make it easy to relax and feel pampered, Julie says, and the accessories add a touch of the unexpected.

"It was fun to spice it up with some different accents," she says. For Julie and her family—and her friends—the bath creates the Ritz-Carlton feel she craved. "It really is like being in a nice hotel," she says.

Opposite: Traditionally styled white vanities continue the neutral palette against the subtle backdrop of pale blue walls. Crystal knobs add sparkle.

Above: Walls of carrara marble and glass give the shower a sleek, clean look. A wide bench runs the width of the shower, and a niche offers space for bath products.

who describes the bath as a "fun, girly space, but with a fresh spa feeling."

The cabinets and countertops are all classic marble, with vintage-style sconces and a crystal chandelier providing a bit of glamour. The lights and mirrors add a reflective quality that capitalizes on the sunshine flooding through the window, which frames an enviable view of Camelback Mountain.

Key to the room's fresh feeling is the quiet palette, featuring a soft, soothing blue, anchored by stretches of white carrara marble. Vallone shaped the marble to create a highly functional yet decorative ledge behind the sinks to reduce clutter on the counter.

The shelf is Julie's favorite detail. "I can put

pretty things or products I use every day right at my disposal," she says.

Old-fashioned fixtures include polished-nickel shower faucets and showerheads, while the sconces hint of Hollywood. "I'm very traditional but really open to throwing in modern or Art Deco," Julie says. "I like that twist!"

The bathroom's traditional elegance and class make it easy to relax and feel pampered, Julie says, and the accessories add a touch of the unexpected.

"It was fun to spice it up with some different accents," she says. For Julie and her family—and her friends—the bath creates the Ritz-Carlton feel she craved. "It really is like being in a nice hotel," she says.



BEAUTIFUL BATHS



In Detail

FINE AMENITIES AREN'T LIMITED TO LUXURY HOTELS. DESIGNER BERKLEY VALLONE SELECTED THESE ELEGANT TOUCHES FOR THE ADELSONS' BATH.

Clockwise from opposite: A recessed area next to the tub provides storage for extra towels and bath lotions. • A ledge behind the sinks is ideal for displaying toiletries and bath essentials in crystal containers. Crystal knobs add a touch of sparkle, and the sconces give the bath a dose of Hollywood glamour. • A rain showerhead was the Adelsons' first choice. To cut water usage, they also installed two alternatives: a regular showerhead and a water-conserving handheld unit. • A chandelier fashioned from crystal and wrought iron adds to the feeling of luxury.

RESOURCES BEGIN ON PAGE 14

In Detail

FINE AMENITIES AREN'T LIMITED TO LUXURY HOTELS. DESIGNER BERKLEY VALLONE SELECTED THESE ELEGANT TOUCHES FOR THE ADELSONS' BATH.

Clockwise from opposite: A recessed area next to the tub provides storage for extra towels and bath lotions. • A ledge behind the sinks is ideal for displaying toiletries and bath essentials in crystal containers. Crystal knobs add a touch of sparkle, and the sconces give the bath a dose of Hollywood glamour. • A rain showerhead was the Adelsons' first choice. To cut water usage, they also installed two alternatives: a regular showerhead and a water-conserving handheld unit. • A chandelier fashioned from crystal and wrought iron adds to the feeling of luxury.

